

DIN Rail and Wall Mounting Brackets



FLANGE/WALL BRACKETS – DEF

New and unique, snap-on easy to fix wall mounting bracket. One size fits all enclosures.

- Fits sizes DE01 – DE06
- Materials: PA66 UL94-V0 flame retardant
- Colours: Grey (G) or black (B)
- Comes with 2x M3 fixing holes

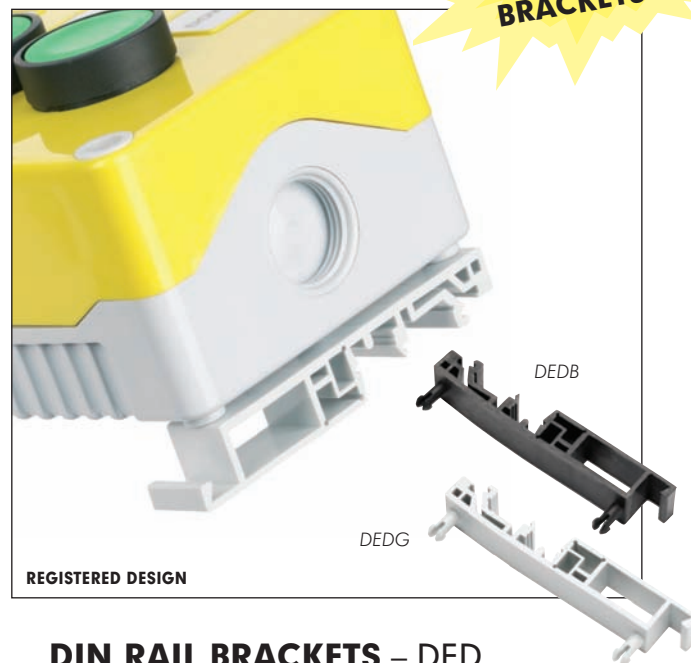

DIN RAIL BRACKETS – DED

New and unique, snap-on Combi foot DIN rail mounting bracket. One size fits all enclosures.

- Fits sizes DE01 – DE06
- Materials: PA66 UL94-V0 flame retardant
- Colours: Grey (G) or black (B)
- Suitable for TS32 and TS35 rails

DEF – FLANGE/WALL BRACKET

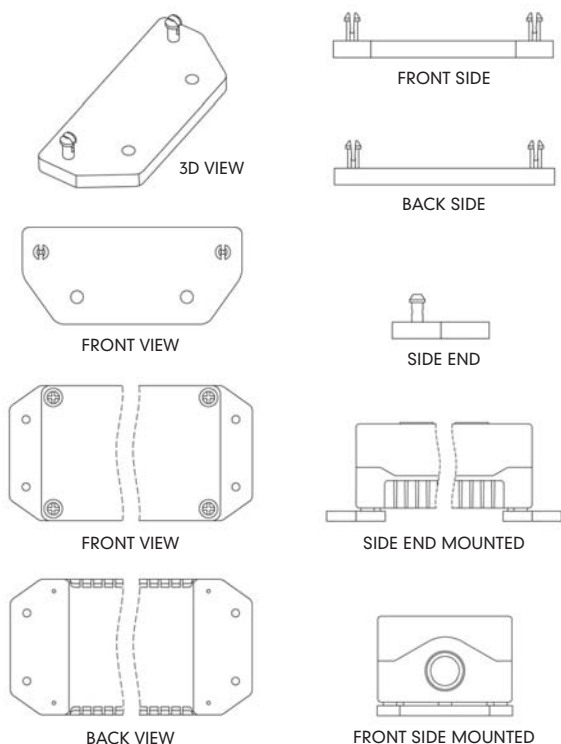

DED – DIN RAIL BRACKET

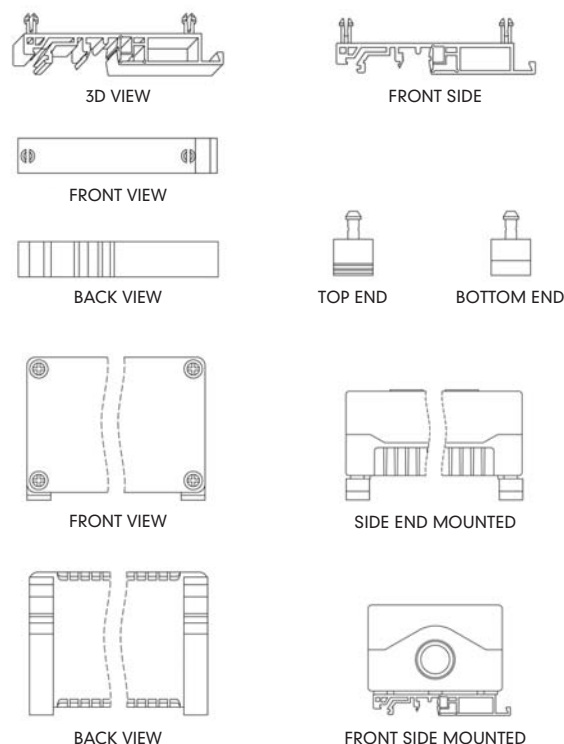

**UNIQUE!
SNAP-ON
BRACKETS**

Cable Glands, Screws and Labels



CABLE GLANDS – DECG

Glands fit all sizes of enclosures.

- Size: H29.2mm GL:10mm Nut: 24mm
- Material: Polyamide 6
- Colours: Grey (G) or black (B)
- M20 x 1.5 thread glands
- Cable range: 3.5-8mm
- Clamping range: 6-12mm
- Protection class: IP68
- Permanent operational temperature: -40°C to +100°C
- Short term max. operational temperature: +150°C
- Seal: Thermoplastic rubber



SCREWS – DES

Screws fit all sizes of enclosures. Additional screws can be ordered.

- Materials: PA66 UL94-V0 flame retardant
- Colours: Grey (G) or black (B)
- Combination head accepts slot and cross head screws

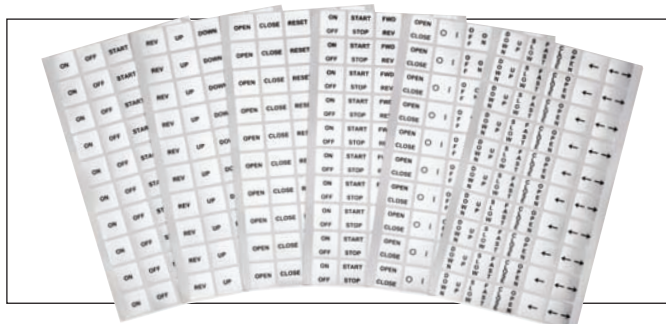

LEGENDS – NCU-61

Strong, silver plastic, self-adhesive legends for use with the 'With Hole Enclosures' and control switches. Legends fit perfectly into the moulded box on enclosure cover.

- Size: 18 x 18mm
- 30 different legends, 50 legends on each sheet.

NCU-61-01 = ON	NCU-61-16 = ON/OFF
NCU-61-02 = OFF	NCU-61-17 = START/STOP
NCU-61-03 = START	NCU-61-18 = FWD/REV
NCU-61-04 = STOP	NCU-61-19 = UP/DOWN
NCU-61-05 = FWD	NCU-61-20 = FAST/SLOW
NCU-61-06 = REV	NCU-61-21 = OPEN/CLOSE
NCU-61-07 = UP	NCU-61-22 = O I
NCU-61-08 = DOWN	NCU-61-23 = OFF/ON
NCU-61-09 = FAST	NCU-61-24 = STOP/START
NCU-61-10 = SLOW	NCU-61-25 = REV/FWD
NCU-61-11 = OPEN	NCU-61-26 = DOWN/UP
NCU-61-12 = CLOSE	NCU-61-27 = SLOW/FAST
NCU-61-13 = RESET	NCU-61-28 = CLOSE/OPEN
NCU-61-14 = EM. STOP	NCU-61-29 = ←
NCU-61-15 = I O	NCU-61-30 = ← →

DECG – CABLE GLAND

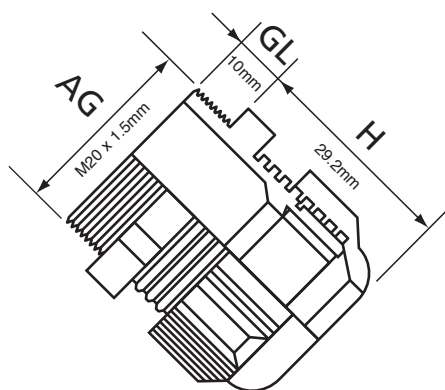

Control Station Accessories

LED BULBS – DBA9

Bulbs fit all sizes and come in the following colours.

- Bulb colours:

Red (**R**)
Yellow (**Y**)
Green (**G**)
Blue (**S**)
White (**W**)



- Voltage rating:

AC/DC 24V (**A**)

AC 380~440V (**M**)

AC/DC 100~120V (**E**)

AC/DC 220~240V (**I**)

PILOT LAMP ROUND HEAD BULB HOLDER – DBA9

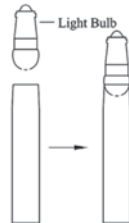

CONTACT BLOCKS – DCB

- DCB-01 Contact block **1b**
brown n/c
- DCB-10 Contact block **1a**
black n/o



MOUNTING ADAPTOR – DPPB30-01

Transfer ring from 22mm to 30mm (2 pcs)



SHROUDS – DM01

Shrouds come in yellow and white with hole.



DM01-OY



DM01-OW

EMERGENCY STOP LEGEND PLATE – DPB22-RO1C

Round, yellow disc with 22Ø hole.

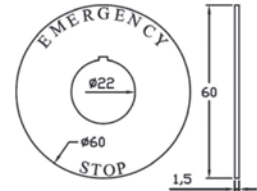

LEGEND HOLDER – DPPB22-01C

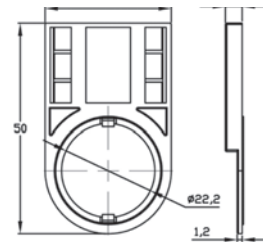

STANDARD LEGEND CODE – DPB22-

01	ON	06	REV	11	O I
02	OFF	07	UP	12	ON OFF ON
03	STOP	08	DOWN	13	FWD OFF REV
04	START	09	RUN	14	MAN OFF AUTO
05	FWD	10	OFF ON	50	BESPOKE

TRANSPARENT BOOTS – DPB22-D06

Rubber rectangular boot

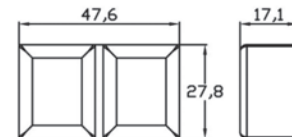
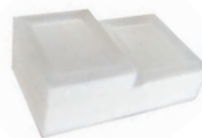

RUBBER CAP – DPPB-P06

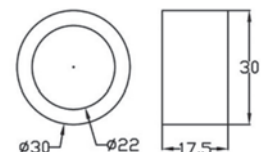

FIXING NUT TOOL – DPPB-02T

